

4th King's John Price Paediatric Respiratory Conference

Bush House, 30 Aldwych, London, WC2B 4BG
Tues 17th – Thurs 19th April 2018

OLD PROBLEMS, NEW CHALLENGES



RCPCH HAS APPROVED THIS CONFERENCE FOR CPD IN
ACCORDANCE WITH THE CURRENT RCPCH CPD GUIDELINES

ENDORSED BY ERS



ERS

EUROPEAN
RESPIRATORY
SOCIETY

Conference Director: **Dr Atul Gupta**
Consultant Respiratory Paediatrician,
King's College Hospital, London

www.paediatricrespiratory.com

CONFERENCE SESSION FLOORPLAN

04: FOURTH FLOOR



02: SECOND FLOOR

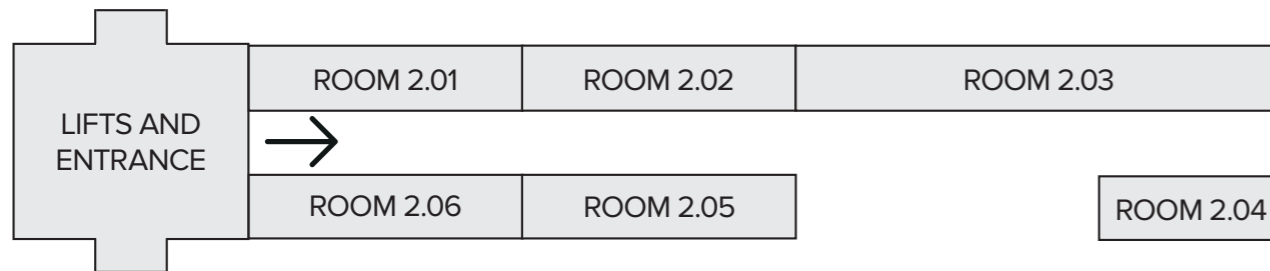

01: FIRST FLOOR



00: GROUND FLOOR



-01: LOWER GROUND FLOOR



WELCOME



On behalf of the organising committee, it is my pleasure to welcome you to the 4th King's John Price Paediatric Respiratory Conference. This meeting has acquired an outstanding reputation among professionals as the forum for sharing new information and discussing the controversial issues around respiratory problems in children. The conference also provides copious opportunities for all healthcare professionals with an interest in paediatric respiratory problems to interact and network with the world's leading experts.

This annual event is now in its 4th year and is unique in a number of ways:

- It boasts a wide ranging faculty consisting of leading experts from Denmark, Greece, Netherlands, USA and UK.
- For the first time, we have chosen to move the conference to Bush House in the West End, in order to enhance the level of interaction and networking. Bush House is a Grade II listed building which previously served as the headquarters of BBC World Service.
- This year's theme 'Old Problems, New Challenges' seeks to discuss the latest evidence in the management of a diverse range of paediatric respiratory problems, particularly addressing difficult and controversial issues. It will try to offer some practical solutions to difficult paediatric respiratory issues.
- The volume and quality of abstracts received has been exciting, and I would like you to visit the posters during the lunch / coffee break times.
- This year, we are fortunate to be supported by a record number of sponsors with exhibitions taking place throughout the event. I would encourage all delegates and faculty to interact with the exhibitors.

I would like to take this opportunity to thank our speakers for sharing their knowledge and our sponsors and exhibitors for helping us provide this opportunity.

And finally thank you to our great team; who made it all happen: Don, Huileng, Hazel, Nicki, Louise, Paolo, Theo, Jane, Suja, Mo, Sue, Becca, Kerry, the King's Paediatric Respiratory team, and the events team, especially Kerry & Becca.

We hope that you enjoy the event and take away valuable learning experiences that you can apply in your practice.

Kind Regards

Atul

» **Dr Atul Gupta**
Conference Director
Consultant in Paediatric Respiratory,
King's College Hospital, London

CONTENTS

- 2 VENUE FLOORPLANS
- 3 WELCOME
- 4 MAIN PROGRAMME 17 APRIL
- 5 PAEDIATRIC SLEEP SYMPOSIUM 17 APRIL
- 6 CHRONIC LUNG DISEASE OF PREMATURITY MASTERCLASS 17 APRIL
- 7 PAEDIATRIC DYSFUNCTIONAL BREATHING MASTERCLASS 17TH APRIL
- 8 MAIN PROGRAMME 18 APRIL
- 9 MEASURING SPIROMETRY IN CHILDREN MASTERCLASS 18 APRIL
- 10 MAIN PROGRAMME 19 APRIL
- 12 EXHIBITOR PROFILES AND FLOORPLAN
- 17 ABSTRACTS AND ACKNOWLEDGEMENTS



OLD PROBLEMS, NEW CHALLENGES - AUDITORIUM

PAEDIATRIC SLEEP - LECTURE THEATRE 2

SESSION 1

- 08:45 Registration, exhibition and networking
- 09.30 **Allergy Testing: Is the Result Relevant?**
Dr Nicola Brathwaite
- 10.00 **Allergy and the Skin: Where it All Starts and Ends**
Dr Helen Brough
- 10.30 **How to Maximize Efficacy in Eczema Treatment**
Dr Rachael Morris-Jones
- 10.50 **Coffee, Exhibition & Networking**

SESSION 2

- 11.20 **United Airways**
Dr Glenis Scadding
- 11.50 **Aero-Allergen Immunotherapy**
Dr Sue Leech
- 12.10 **Prebiotics and Probiotics for Allergic and Respiratory Diseases**
Dr Sue Leech
- 12.30 **Future Directions in Allergy Management**
Dr Adam Fox
- 13.05 **Lunch, Exhibition & Networking**
- 13.10 **Positivity in Practice**
Lunchtime session - Room 2.06
Suja Chandran

This session explores the practice and benefit of using positive affirmations in the workplace and how to apply positive thinking in difficult work situations. Through reflection and meditation, it gives an opportunity to practice a technique for steering away from negative thinking towards positive thinking.



SESSION 3

- 14.00 **An Integrated Approach to Asthma Management - Do We Really Need It?**
Prof Monica Lakhanpaul
- 14.30 **Anxiety & Risk Taking Behaviour in Children With Respiratory Illness**
Dr Fran Beresford
- 15.00 **Compare and Contrast NICE and SIGN/BTS Asthma Guidance**
Dr Atul Gupta
- 15.30 **Early Viral Infections: Long Term Consequences**
Dr Rania Abusamra
- 16.00 **Coffee, Exhibition & Networking**

SESSION 4

- 16.30 **How the RCPCH is Supporting Children's Research**
Prof Neena Modi
- 16.45 **Afternoon Tea with Janus - Looking Both Ways**
Prof Andy Bush
- 17.15 **Determinants of Survival in Complex Paediatric Disease: Lessons from a Simpler Age**
Prof Robert Wood
- 17.35 **Respiratory Outcomes of Prematurity**
Prof Anne Greenough
- 18.00 **Welcome Drinks Reception**
8th Floor, Terrace at Bush House
- 19.00

FOLLOW US ON TWITTER



- 08:30 Registration, Exhibition & Networking
- 09.00 **Welcome & Introductions**
- 09.05 **Sleep Problems in Children: Common, Important But Frequently Undiagnosed / What is Normal and What is Abnormal in Sleep?**
Dr Francois Abel
- 09.30 **When and Why to Treat the Child Who Snores**
Dr Huileng Tan
- 10.00 **The Central Apnoea Spectrum - When Does Normal Become Abnormal?**
Dr Don Urquhart
- 10.30 **Coffee, Exhibition & Networking**
- 11.00 **Sleep Studies: What Do We Measure and Why Do We Measure it? Basics of Sleep Study Scoring Setting Up**
Dr Andrew Morley
- 11.30 **Understanding Sleep in the Newborn Period: What's Normal and What Triggers Further Investigation?**
Dr Hazel Evans
- 12.00 **Sleep Like a baby? Sleep Tips from Baby to Adult**
Dr Mike Farquhar
- 12.30 **Lunch, Exhibition & Networking**
- 13.30 **Oximetry for the Diagnosis of OSAS in Childhood When Polysomnography is Not Available.**
Dr Athanasios Kaditis
- 14.10 **Excessively Sleepy Children**
Prof Paul Gringras
- 14.50 **Is Polysomnography the Gold Standard (or gold mine) in 2018? Pro / Con Debate**
Dr Neil Gibson
Dr Mark Rosenthal
- 15.50 **Sleep / NIV Award Presentation Role of CO2 Monitoring in the Diagnosis and Management of Paediatric Sleep Disordered Breathing**
Federica Trucco

- 16.00 **Coffee, Exhibition & Networking**
- 16.30 **NEXT SESSION - Auditorium**
- 16.30 **How the RCPCH is Supporting Children's Research**
Prof Neena Modi
- 16.45 **Afternoon Tea with Janus - Looking Both Ways**
Prof Andy Bush
- 17.15 **Determinants of Survival in Complex Paediatric Disease: Lessons from a Simpler Age**
Prof Robert Wood
- 17.35 **Respiratory Outcomes of Prematurity**
Prof Anne Greenough
- 18.00 **Welcome Drinks Reception**
8th Floor, Terrace at Bush House
- 19.00

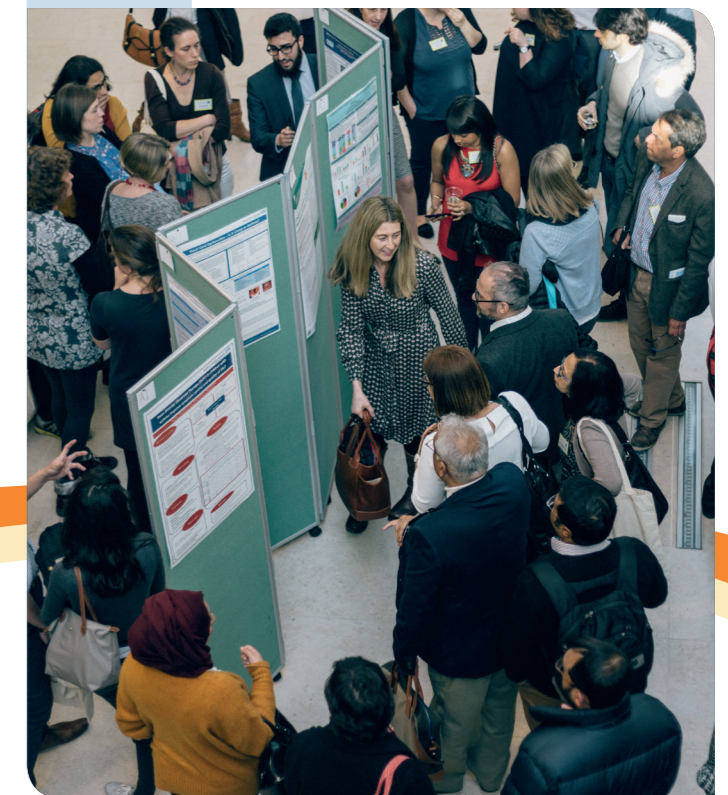

CHRONIC LUNG DISEASE OF PREMATURITY: CONTROVERSIES AND CONSENSUS – NEW DIMENSIONS TO EXPLORE - Room 2.03

PAEDIATRIC DYSFUNCTIONAL BREATHING: DIAGNOSIS TO DISCHARGE - Room 2.01

08:30 Registration, Exhibition & Networking

09.00 Welcome & Introductions

09.05 Prevention and Management of Bronchopulmonary Dysplasia in the Neonatal Unit
Dr Theodore Dassios

This session will aim to cover:

- Preventive strategies in cases identified as being at increased risk of BPD
- Invasive and non-invasive ventilation in BPD
- Evolution of early BPD
- Early origins and interventions that are associated with later development of BPD

10.00 Management of Chronic Lung Disease of Prematurity Outside Neonatal Unit
Dr Jayesh Bhatt

This session will aim to cover:

- Developing a pathway (When to refer / involve respiratory team)
- When to investigate for co-morbidities in severe disease or when difficult to wean (aspiration lung disease, GORD, optimising nutritional management)
- When to consider complex investigations like HRCT Chest, flexible bronchoscopy, complex sleep studies
- Role of diuretics / steroids / Azithromycin
- Palivizumab / RSV vaccines

10.55 Coffee, exhibition and networking

11.20 Imaging Neonatal Lung Diseases - A Practical Guide
Dr Tom Semple

This session will aim to cover the role of:

- Imaging appearances of neonatal lung diseases (including BPD and infant onset ChILD entities)
- Practicalities of imaging neonates (GA/sedation vs immobilisation devices and faster scanners)
- IV contrast vs non-contrast (pros and cons)
- Ionising radiation exposures from CT examinations - shift in risk/benefit balance from old to new scanners
- Role of the chest radiograph and thoracic/respiratory applications of ultrasound.
- When to use CT
- Future prospects in neonatal thoracic imaging
- Questions / discussion

12.30 Sanjay Valappil Memorial Award Oral Presentation

Inhaled Nitric Oxide Use in Persistent Pulmonary Hypertension of the Newborn: A Retrospective Audit in a Neonatal Intensive Care Unit.
Beatrice Zanetti

12.40 Lunch, Exhibition & Networking

13.40 Feeding Considerations in Infants with Chronic Lung Disease of Prematurity
Ashley Dean

This session will aim to cover:

- Overview of feeding skill development
- Role of the speech and language therapist (SLT)
- The role of synchronicity in infant feeding
- When to refer to SLT
- What to consider when feeding infants with CLD
- Dysfunctional swallow / silent aspiration
- When to refer for Videofluoroscopy
- Risk benefit of Videofluoroscopy

14.05 Genetic Disorders of Surfactant Protein Dysfunction: When to Consider and How to Investigate
Dr Atul Gupta

This session will aim to cover:

- Overview of the genetic surfactant protein dysfunction syndromes
- Clinical features of the surfactant protein dysfunction syndromes
- When to suspect this diagnosis
- How to investigate it
- Current treatment options.

14.30 Weaning of Oxygen in Infants with Chronic Lung Disease of Prematurity
Dr Hazel Evans (HE)
Dr Jayesh Bhatt (JMB)

This session will aim to cover:

- Performing and interpreting oximetry in infant (HE)
- overview of setting up an oximeter (HE)
- oximetry home service (JMB)
- How to analyse oximetry traces (JMB)
- Case based discussion on weaning children with Chronic lung disease of Prematurity from supplemental oxygen using oximetry as a weaning tool (JMB)
- Case based discussion on managing babies who fail to wean off ventilation/high flow (HE)
- Limitations of oximetry studies (HE)

15.30 Social Media, Ethics..... Decisions
Dr Joe Brierley

16.00 Coffee, Exhibition & Networking

SESSION 4

16.30 NEXT SESSION - Auditorium

16.30 How the RCPCH is Supporting Children's Research
Prof Neena Modi

16.45 Afternoon Tea with Janus - Looking Both Ways
Prof Andy Bush

17.15 Determinants of Survival in Complex Paediatric Disease: Lessons from a Simpler Age
Prof Robert Wood

17.35 Respiratory Outcomes of Prematurity
Prof Anne Greenough

18.00 Welcome drinks reception
8th Floor, Terrace at Bush house

08:45 Registration, exhibition and networking

09.00 Welcome and Introduction to Dysfunctional Breathing - Room 2.01
Dr Paolo Pianosi

The day's sessions will aim to cover:

- What is dysfunctional breathing and when to suspect it.

09.30 Theoretical Construct Dyspnoea - Room 2.01
Dr Paolo Pianosi

This session will aim to cover:

- how we perceive dyspnoea – stimuli, neural mechanisms, fMRI
- language of dyspnoea – how do patients describe it
- how do we measure it

10.15 Coffee, exhibition and networking

10.45 Practical Approach to Investigation - Room 2.01
Dr Louise Fleming

This session will aim to cover the role of:

- A structured approach to the child with breathlessness
- Spirometry
- Simple exercise testing
- Complex exercise testing including CPET and Laryngoscopy
- Comorbidities contributing to dysfunctional breathing

11.30 Therapeutic Modalities - Room 2.01
Dr Nicki Barker

This session will aim to cover:

- Assessment tools
- Aims of treatment
- Framework for interventions
- Anticipated outcomes

12.15 Lunch, exhibition and networking

13.15 PARALLEL SESSIONS

STREAM A: Room 2.01 Practical session on Therapeutic Intervention Strategies
Dr Nicki Barker

This session will aim to cover:

- Assessment tools
- Framework for interventions
- Treatment techniques
- Anticipated and actual outcomes

STREAM B: Room 2.02 Dysfunctional Breathing: PFT Lab Principles
Dr Paolo Pianosi

This session will aim to promote:

- Understanding technical requirements for satisfactory spirometry
- Awareness of options for bronchoprovocation challenge
- Interpretation of these diagnostic tests

STREAM C: - Room 2.06 How to Investigate Dysfunctional Breathing
Dr Louise Fleming

This session will aim to cover the role of:

- Simple exercise testing
- Complex exercise testing including CPET and EVH
- Continuous laryngoscopy during exercise

14.15 Coffee, Exhibition & Networking

14.30 PLENARY - Room 2.01 Participants Present Cases for Group Discussion

This session will aim to promote:

- Application of learning to real case situations
- Interpretation of diagnostic information
- Discussion of different management options
- Multidisciplinary working for patient benefit

15.15 Troubleshooting and Questions/Discussion - Room 2.01
Dr Nicki Barker, Dr Louise Fleming, Dr Paolo Pianosi

This session will include:

- Barriers to success
- Approaches to challenging patients
- Opportunities for questions/discussion and closing remarks

16.00 Coffee, exhibition and networking

SESSION 4 - Auditorium

16.30 NEXT SESSION

16.30 How the RCPCH is Supporting Children's Research?
Prof Neena Modi

16.45 Afternoon Tea with Janus - Looking Both Ways
Prof Andy Bush

17.15 Determinants of Survival in Complex Paediatric Disease: Lessons from a Simpler Age
Prof Robert Wood

17.35 Respiratory Outcomes of Prematurity
Prof Anne Greenough

18.00 Welcome drinks reception
8th Floor, Terrace at Bush house

This course aims to provide better understanding of dysfunctional breathing in children from the diagnosis to discharge.

OLD PROBLEMS, NEW CHALLENGES

08:30	Registration, Exhibition & Networking
08.30	PERSONAL PRACTICE SESSION Smoking Cessation in Paediatric Clinics & CO Testing - Room 2.01 Ms Mira Osinibi Taking Children on Aeroplanes: Who to Test and Why? - Lecture Theatre 1 Dr Cara Bossley The Toxicity of E-cigarettes and Children's Respiratory Health - Lecture Theatre 2 Dr Anil Shenoy
09.10	Welcome Address SESSION 5 - Auditorium 09.15 Challenging Long Standing Assumptions for Respiratory Infections Prof Steve Cunningham 09.45 Transition to Adult Care What Have We Learnt From CF Dr Colin Wallis
10.15	KEYNOTE LECTURE How Can We Prevent Adult Airway Disease During Childhood? Prof Fernando D. Martinez
11.00	Coffee, exhibition and networking
	SESSION 6: PARALLEL SESSIONS
11.30 -12.30	SESSION A: Auditorium 49 Ways To Get the Wrong Answer When You Do A Paediatric Bronchoscopy Prof Robert Wood
11.15 -12.50	SESSION B: Lecture Theatre 1 Interpretation of Paediatric Oximetry Dr Hazel Evans
12.30 -13.30	Lunch, exhibition and networking
	SESSION 7
13.30	STREAM A: Auditorium Pearls STREAM B: Lecture Theatre 1 Acute and Chronic Non Invasive Respiratory Support
13.30	A: Who Needs PCD Testing? Auditorium Prof Claire Hogg B: Introduction to Non-Invasive Ventilation and Respiratory Support in Children Lecture Theatre 1 Dr Don Urquhart

14:00	A: POTS, Hyperventilation and Dysfunctional Breathing: Is It All In Their Heads? - Auditorium Dr Paolo Pianosi B: Initiation and Monitoring of Long Term CPAP/NIV - Lecture Theatre 1 Dr Huileng Tan
14.30	A: SNAPPS Out Of It - No Time to Supervise the Junior Doctor - Auditorium Prof Paul Brand B: Practical and Technical Aspects of Non Invasive Positive Airways Pressure in Children - Lecture Theatre 1 Dr Michelle Chatwin
15.00	Coffee, exhibition and networking
	SESSION 8
15.30	STREAM A: Auditorium LPRG Grand Rounds 'must not miss cases' STREAM B: Lecture Theatre 1 Acute and chronic Non Invasive Respiratory Support
	A: Cough and Crepitus: An Unusual Case of Pneumomediastinum - Auditorium Dr Claire Edmondson B: Acute Non-Invasive Ventilation in Children - Lecture Theatre 1 Dr Catherine McDougall
15.50	A: Case 2 - Auditorium Dr Sormeh Salehian
16.10	A: It's Not the Heart, Must Be The Lungs.... and Sometimes It Is - Auditorium Dr Chris Grime B: High-Flow Humidified Nasal Cannula Oxygen Therapy in Children - How does it work? - Indications - How to use it - Lecture Theatre 1 Prof Paul Seddon
16.30	A: Adolescent Chronic Cough - 'Still Round The Corner There May Wait, A New Road or a Secret Gate.' - Auditorium Dr Anna-Louise Nichols
16.50	A: Award Oral Presentation; Podcast - Auditorium Shravanthi Kummaraganti
17.00	Tea & Coffee 8th Floor, Terrace at Bush House
17.15	Severe Asthma: Where are our patients and what should be done with them? Dr Louise Fleming, Dr Will Carroll Promotional Symposium organised and funded by Novartis.
18.45	Dinner

MEASURING SPIROMETRY IN CHILDREN - Lecture Theatre 2

09.00	Registration, Exhibition & Networking
09.15	Welcome & Introductions
09.20	Overview of Paediatric Respiratory Physiology Dr Jane Kirkby The aims of this session are: <ul style="list-style-type: none"> To have a basic understanding of the physiology underpinning lung function, in particular the flow-volume loop. To understand the importance of lung growth and development and the impact this has on lung function. To appreciate why we measure lung function in children
10.30 -11.30	Set Up and Use of Spirometry Equipment Dr Jane Kirkby, Sindhu Sivagnanasithiyar The aims of this session are: <ul style="list-style-type: none"> To have an awareness of the different types of spirometers available and advantages/limitations of each device Have knowledge on the set-up and maintenance of spirometry equipment Understand the importance of regular calibrations This session will include a brief practical session
11.00	Coffee
11.30	Basics of Spirometry Dr Jane Kirkby, Sindhu Sivagnanasithiyar The aims of this session are: <ul style="list-style-type: none"> To understand the basic requirements prior to performing spirometry To gain some practical experience in performing spirometry To understand the importance of selecting technical acceptable measurements Be able to identify unacceptable/erroneous results This session will include a brief practical session
12.30	Lunch, exhibition and networking
13.30	Bronchodilator Response Dr Jane Kirkby, Sindhu Sivagnanasithiyar The aims of this session are: <ul style="list-style-type: none"> To understand when and why an assessment of bronchodilator responsiveness may be useful To have knowledge of the different methods of administering bronchodilators and determining a positive response
14.00	Interpretation of Spirometry Dr Jane Kirkby The aims of this session are: <ul style="list-style-type: none"> To be aware of different pathological disorders and understand the difference between obstructive and restrictive respiratory defects To understand the how to select and apply appropriate reference data To use reference data to interpret results and ascertain if results are within the normal limits
15.30	Case Studies Dr Jane Kirkby, Sindhu Sivagnanasithiyar The final session will be series of case-studies for participants to interpret



FOLLOW US ON TWITTER



OLD PROBLEMS, NEW CHALLENGES

08:15	Registration, Exhibition & Networking		
08.30	PERSONAL PRACTICE SESSIONS		
	My Career, If I Knew Then What I Know Now. Leading Education and Clinical Services - Room 2.01 & 2.02 Dr Simon Broughton		
	Imaging of Paediatric Lung Diseases - A Practical Guide... Being Picky Lecture Theatre 1 Dr Tom Semple		
	Tobacco Dependency: A Long Term Relapsing Condition That Begins in Childhood Lecture Theatre 2 Dr Noel Baxter		
	SESSION 9 - Auditorium		
09.30	Are Inhaled Corticosteroids Harmful in Children? Prof Paul Brand		
10.00	After the Lancet Asthma Commission: Asthma, Asthmas or Airway Disease? Prof Andy Bush		
10.30	Is Asthma Over or Under Diagnosed in Children? Dr James Y. Paton		
11.00	Coffee, Exhibition & Networking		
	SESSION 10 - Auditorium		
11.30	The Conundrum of Paediatric Tracheomalacia Prof Robert E. Wood		
12.15	Lung Function Trajectories from Childhood to Adulthood: Is COPD a Paediatric Disease (too)? Prof Fernando D. Martinez		
12.45 -13.35	Lunch, Exhibition & Networking		
	SESSION 11: PARALLEL SESSIONS		
13.35 -15.15	STREAM A: Auditorium Asthma		
	STREAM B: Lecture Theatre 1 Cystic Fibrosis		
13:35 -13:45	A: Asthma Award Presentation		
	Air Pollution: Effects of Biomass Burning Generated Particulate Matter on Bronchial Epithelial Cells - Auditorium Dr Biju Thomas		
		B: Caro Minasian Memorial Award Oral Presentation	
		Early Development of the Airway Microbiota in Infants With CF - Lecture Theatre 1 Dr Bushra Ahmed	
13:45 -14:15		A: Corticosteroid Responsiveness in Childhood Asthma; a Multi-Domain Approach to Test Response to Treatment - Auditorium Dr Cara Bossley	
		B: Recent Advances in the Management of Cystic Fibrosis - Lecture Theatre 1 Prof Jane Davies	
14:15 -14:45		A: Asthma: Therapeutic Advances - Auditorium Dr Atul Gupta	
		B: Early Airway Disease How Aggressive Should We Be? Are We Taking Advantage of Newborn Screening? - Lecture Theatre 1 Dr Kevin Southern	
14:45 -15:15		A: Ella Roberta Family Foundation Research Award for Asthma (Joint Award) - Auditorium	
		A: Using Remote Direct Observation Therapy to Improve Asthma Inhaler Technique - Auditorium Charles Southey	
		A: The Role of Pet Allergen Sensitisation and Exposure in Asthmatic Children - Auditorium Shahamah Alshahr	
		B: An Update on Nontuberculous Mycobacteria in Cystic Fibrosis - Lecture Theatre 1 Dr Gary Ruiz	
15.05	Coffee, Exhibition & Networking		
	SESSION 12 - Auditorium		
15:35	Antibiotic Treatment of Exacerbation of Early Childhood Asthma Prof Hans Bisgaard		
16:15	How Can We Improve Patient Adherence? Prof Rob Horne		
16:45	Allergen Exposure and Avoidance in Asthma Treatment and Prevention Prof Adnan Custovic		
17:15 -17:30	Vote of Thanks Dr Atul Gupta		

Aptamil Pepti

for the effective management of cows' milk allergy



RELIEVE
cows' milk allergy symptoms¹
with **97% efficacy**²

REDUCE
incidence of atopic dermatitis
up to five years³



NOW PROVEN⁴

REASSURE
with the **UK's most palatable**
extensively hydrolysed formula^{4*}

For further information contact our Healthcare Professional Helpline on **0800 996 1234** or visit www.eln.nutricia.co.uk/cma

References: 1. Verwimp JJ *et al.* Eur J Clin Nutr. 1995;49 (Suppl1):S39-S48. 2. Giampietro PG *et al.* Pediatr Allergy Immunol. 2001;12:83-86. 3. Arslanoglu S *et al.* J Biol Regul Homeost Agents. 2012;26:49-59. 4. Campden BRI conducted a blind taste test using a home usage design with a sample of 100 Dietitians and General Practitioners from 16.11.2016 to 09.12.16. Participants rank ordered the extensively hydrolysed formula (EHF) milk samples (Danone Aptamil Pepti, Abbott Similac Alimentum, Nestle SMA Althera and Mead Johnson Nutramigen LGG) in term of overall liking and answered a series of attitudinal questions in relation to the impact of EHF's palatability on infants with CMA and their families. The results from the ranking showed that the Danone Aptamil Pepti sample was liked significantly more than all the other three samples tested.

* A home usage test assessment was carried out between 16/11/16 and 9/12/16 on the 4 products indicated for cows' milk allergy from birth and included 100 UK healthcare professionals.

IMPORTANT NOTICE: Aptamil Pepti 1 & 2 are foods for special medical purposes for the dietary management of cows' milk allergy. They should only be used under medical supervision, after full consideration of the feeding options available including breastfeeding. Aptamil Pepti 1 is suitable for use as the sole source of nutrition for infants from birth, and/or as part of a balanced diet from 6-12 months. Aptamil Pepti 2 is suitable for babies over 6 months as part of a mixed diet.

17-026 / June 2017



STAND: 25

At Nutricia Early Life Nutrition, we develop high-quality nutritional solutions to support the health of pregnant and breastfeeding women, infants and young children. We believe each new generation should be healthier than the one before and together - with parents and healthcare professionals - we can make a difference.



STAND: 16



STAND: 12

Halyard Health is a medical technology company focused on advancing health and healthcare by delivering clinically-superior products and solutions in infection prevention, surgical solutions, respiratory health, digestive health, IV therapy and pain management. Halyard sells its recognised brands and products in more than 100 countries, and holds leading market positions in multiple categories across the portfolio. For more information, visit www.halyardhealth.co.uk.



STAND: 11

AstraZeneca is a global, science-led biopharmaceutical company that focuses on the discovery, development and commercialisation of prescription medicines, primarily for the treatment of diseases in three therapy areas: Oncology, Cardiovascular, Renal & Metabolism and Respiratory. The Company also is selectively active in the areas of autoimmunity, neuroscience and infection. AstraZeneca operates in over 100 countries and its innovative medicines are used by millions of patients worldwide. For more information, please visit www.astrazeneca.co.uk and follow us on Twitter @AstraZenecaUK



STAND: 26

Vertex is a global biotechnology company that invests in scientific innovation to create transformative medicines for people with serious and life-threatening diseases. We discovered and developed the first medicines to treat the underlying cause of cystic fibrosis (CF), a rare, life-threatening genetic disease. In addition to clinical development programs in CF, Vertex has more than a dozen ongoing research programs focused on the underlying mechanisms of other serious diseases. Our corporate headquarters is now located in Boston, and our international headquarters is in London, UK.



STAND: 24

LogixX Pharma is a speciality pharmaceutical company based in the UK. The company has quickly established itself in the UK market by acquiring the rights to market and distribute innovative Pharmaceutical, OTC and Medical Device products. LogixX Pharma's lead product is Prednisolone 5mg/5ml Oral Solution - an immediate use oral liquid, which offers a pleasant honey and vanilla/cream flavour, ideal for children and adults who struggle to swallow prednisolone tablets, or do not tolerate soluble tablets. Niche therapeutic conditions represents an exciting growth opportunity for LogixX Pharma as many of these conditions are poorly treated with a high level of unmet medical needs.

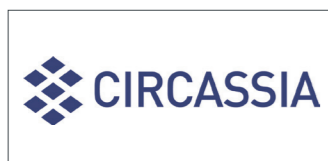

STAND: 10

Circassia is a speciality pharmaceutical company focused on respiratory disease. Our market-leading NIOX® products are used by specialists around the world to measure airway inflammation at the point of care and aid asthma diagnosis and management.



STAND: 06

Getinge is a global provider of innovative solutions for operating rooms, intensive-care units, sterilization departments and for life science companies and institutions. Our extensive portfolio of trusted products, solutions and consulting services have been brought together under one single brand - Getinge. With brands like Maquet, Lancer, Atrium, Pulsion, Datascope, Steritec and Stericool - just to name a few - we are now a global market leader in many healthcare and life science segments. Based on our first-hand experience and close partnerships with clinical experts, healthcare professionals and medtech specialists, we are improving every-day life for people, today and tomorrow. www.getinge.com



STAND: 04

Olympus aims to continuously find better and more economical solutions to medical issues, which improve the well-being of patients, enhance the working environment for doctors and nursing staff and helps to develop the overall performance of health care providers. Working closely with healthcare professionals every day, Olympus matches its innovative capabilities in medical technology and precision manufacturing with their skills to provide the best possible outcomes for patients and society. As healthcare professionals focus on early detection of diseases and minimally invasive procedures, Olympus is there to deliver the diagnostic and therapeutic technologies they need to treat their patients in the field of respiratory endoscopy.



STAND: 05

TM-UK is committed to enhancing the quality of life for people of all ages with respiratory conditions. We are part of Trudell Medical International, a family owned healthcare company that designs, develops and manufactures a wide range of high quality, innovative medical devices and is home to a global Aerosol Lab and Research Centre. **New AeroChamber Plus* Flow-Vu* Anti-Static Valved Holding Chamber (VHC)** and our award-winning **Aerobika* OPEP device**, are now available on prescription in the UK. Come and see us to find out more.

King's John Price Paediatric Respiratory Conference BUSH HOUSE, LONDON

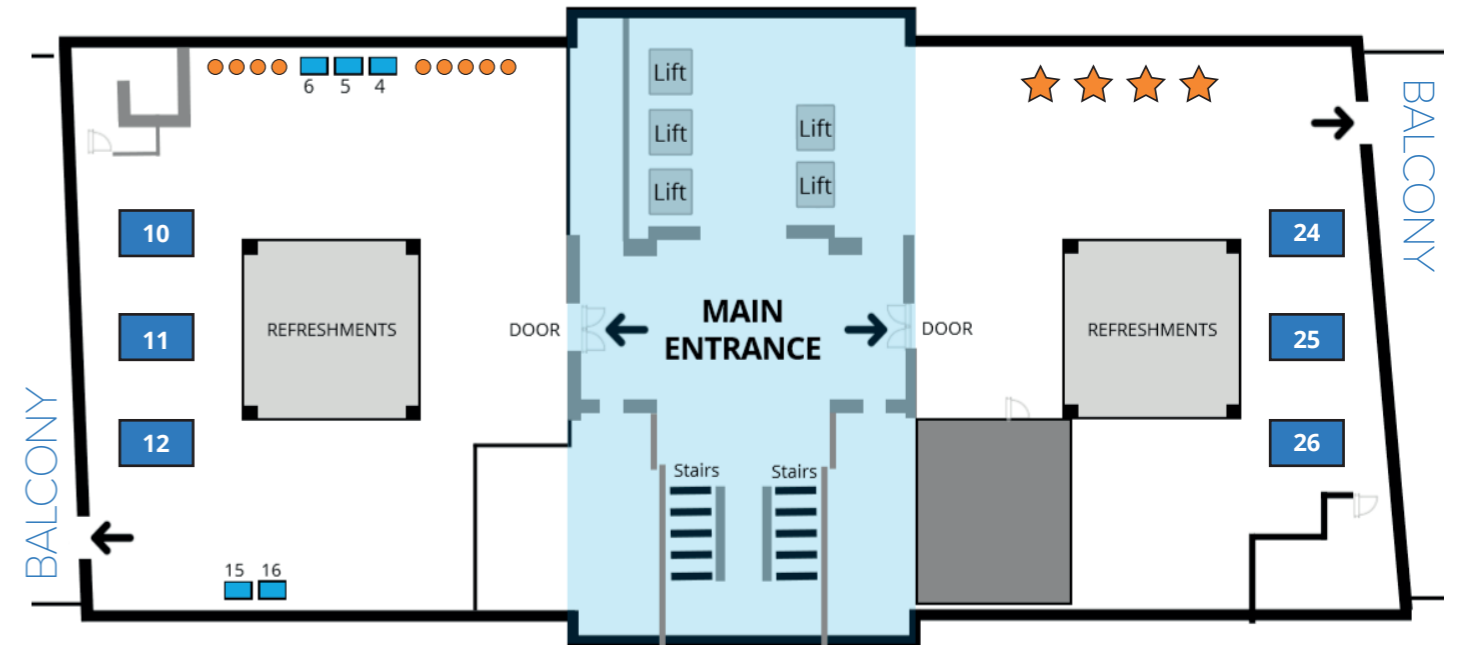

KEY

- Posters
- ★ Prize winning Posters
- Premium stands
- Stands



STAND: 15

Novartis provides innovative healthcare solutions that address the evolving needs of patients and societies. Headquartered in Basel, Switzerland, Novartis offers a diversified portfolio to best meet these needs: innovative medicines, eye care and cost-saving generic pharmaceuticals. For more information, please visit www.novartis.co.uk



STAND: 06

AbbVie is a global, research-based biopharmaceutical company formed in 2013 following separation from Abbott Laboratories. The company's mission is to use its expertise, dedicated people and unique approach to innovation to develop and market advanced therapies that address some of the world's most complex and serious diseases. Together with its wholly-owned subsidiary, Pharmacyclics, AbbVie employs more than 28,000 people worldwide and markets medicines in more than 170 countries. For further information on the company and its people, portfolio and commitments, please visit www.abbvie.co.uk



STAND: 04

Radiometer develops, manufactures and markets solutions for blood sampling, blood gas analysis, transcutaneous monitoring, immunoassay testing and related IT management systems under the ABL, AQT, TCM, AQUIRE, PICO, CLINITUBES and QUALICHECK brand names. With our leading position within blood gas analysis, Radiometer is dedicated to improving global healthcare by ensuring reliable, fast and easy patient diagnoses at hospitals, clinics and laboratories in over 130 countries. Radiometer solutions help caregivers make life-saving diagnostic decisions by accurately offering information on the most critical parameters in acute care testing, in settings such as intensive care units (ICUs), emergency departments (EDs) and operating rooms (ORs).



STAND: 05

The MDDUS is a UK wide, mutual organisation providing indemnity, advice and guidance on medico-legal matters to members who encounter professional difficulties for over 100 years. With a team of highly qualified and experienced professionals, and offices in London and Glasgow, MDDUS prides itself on providing members with a quality, personalised service at competitive rates. Visit our stand or www.mddus.com for more information.

Prednisolone 5mg/5ml Oral Solution vs Prednisolone 5mg Soluble Tablets*
Patient Acceptability Survey
Glasgow Royal Hospital for Children (Emergency Department)

Prednisolone 5mg/5ml Oral Solution is an immediate use oral liquid, which offers an ideal alternative to Prednisolone 5mg Soluble Tablets for both children and adults who have difficulty swallowing prednisolone tablets.



In a two week independent NHS Patient Acceptability Survey (Glasgow)¹ Prednisolone 5mg/5ml Oral Solution was made available for use in all patients who required oral prednisolone for management of an acute wheezing episode:

- 83% of parents (n = 19/23) confirmed that Prednisolone 5mg/5ml Oral Solution tastes better than Prednisolone 5mg Soluble Tablets (n = 23).
- 78% of parents (n = 18/23) confirmed that their child preferred taking Prednisolone 5mg/5ml Oral Solution to Prednisolone 5mg Soluble tablets.
- 15% patients (n = 4/27) treated with Prednisolone 5mg Soluble Tablets required re-administration due to vomiting or expulsion.
- None of the patients treated with Prednisolone 5mg/5ml Oral Solution required re-administration.
- On a satisfaction scale it showed that hospital staff were **more** satisfied with the drug administration of Prednisolone 5mg/5ml Oral Solution than with Prednisolone 5mg Soluble Tablets.

Prednisolone 5mg/5ml Oral Solution is the only liquid formulation of Prednisolone on the CMU contract. (National CMU tender award started November 1st 2016) - CMU price £7.40

Link-Code: PRE1372B Pip-Code: 120-2472 EAN: 5060347610015

PLEASE REFER TO THE
 SUMMARY OF PRODUCT CHARACTERISTICS
 FOR FULL PRODUCT INFORMATION ON:
www.medicines.org.uk

Adverse events should be reported. Reporting forms and information can be found at www.mhra.gov.uk/yellowcard. Adverse events should also be reported to LogixX Pharma medical: +44(0)1908 363 454 or Email: mi@logixxpharma.com

¹ Small scale independent Patient Acceptability Survey conducted (S. Foster et al, Dec 2016) by NHS Greater Glasgow and Clyde Royal Hospital for Children (NHSGCC) comparing patient acceptability of Prednisolone 5mg/5ml Oral Solution vs Prednisolone 5mg Soluble Tablets.

FeNO by  NIOX®

Applying Science with a Single Breath

NIOX VERO® Gives You Knowledge in Numbers

Quick and Easy FeNO Measurement at the Point of Care

Using NIOX VERO with other monitoring tools can provide greater insight to guide **assessment and treatment of Th2-driven airway inflammation.**¹⁻⁴

It helps to identify **ICS-responsive patients**,^{2,5} optimize **ICS dosing**,^{3,4,6-8} monitor patient **adherence**^{9,10} as well as to improve **cost efficiency.**¹¹⁻¹⁴

FeNO measurement with NIOX® is reliable, and provides an **accurate result in a single measurement.**¹⁵

IMPORTANT INFORMATION REGARDING NIOX VERO®

NIOX VERO is a portable system for the non-invasive quantitative simple and safe measurement of Nitric Oxide (NO) in human breath. Nitric Oxide is frequently increased in some inflammatory processes such as asthma and decreases in response to anti-inflammatory treatment. FeNO measurements should be used as part of a regular assessment and monitoring of patients with these conditions. NIOX VERO is suitable for patients age 4 and above. As measurement requires patient cooperation, some children below the age of 7 may require additional coaching and encouragement. NIOX VERO can be operated with 2 different exhalation times, 10 seconds and 6 seconds. The 10 second mode is the preferred mode. For children who are not able to perform the 10 second test, the 6 second is an alternative. The 6 second test should be used in caution with patients over the age of 10. It should not be used in adult patients. Incorrect use of the 6 second exhalation may result in falsely low FeNO values, which can lead to incorrect clinical decisions.

1. Alving K et al. Basic aspects of exhaled nitric oxide. Eur Respir Mon. 2010;49:1-31. 2. Dweik RA et al; on behalf of the American Thoracic Society Committee on Interpretation of Exhaled Nitric Oxide Levels (FeNO) for Clinical Applications. An official ATS clinical practice guideline: interpretation of exhaled nitric oxide levels (FeNO) for clinical applications. Am J Respir Crit Care Med. 2011;184(5):602-615. 3. Smith AD et al. Use of exhaled nitric oxide measurements to guide treatment in chronic asthma. N Engl J Med. 2005;352(21):2163-2173. 4. Powell H et al. Management of asthma in pregnancy guided by measurement of fraction of exhaled nitric oxide: a double-blind, randomised controlled trial. Lancet. 2011;378(9795):983-990. 5. Smith AD et al. Exhaled nitric oxide: a predictor of steroid response. Am J Respir Crit Care Med. 2005;172(4):453-459. 6. Syk J et al. Anti-inflammatory treatment of atopic asthma guided by exhaled nitric oxide: a randomized, controlled trial. J Allergy Clin Immunol Pract. 2013;1(6):639-648. 7. Szeer SJ et al. Management of asthma based on exhaled nitric oxide in addition to guideline-based treatment for inner-city adolescents and young adults: a randomised controlled trial. Lancet. 2008;372(9643):1065-1072. 8. Petsky HL et al. Management based on exhaled nitric oxide levels adjusted for atopy reduces asthma exacerbations in children: a dual centre randomized controlled trial. Pediatr Pulmonol. 2015;50(6):535-543. 9. Beck-Ripp J et al. Changes of exhaled nitric oxide during steroid treatment of childhood asthma. Eur Respir J. 2002;19(6):1015-1019. 10. Delgado-Corcoran C et al. Exhaled nitric oxide reflects asthma severity and asthma control. Pediatr Crit Care Med. 2004;5(1):48-52. 11. LaForce C et al. Impact of exhaled nitric oxide measurements on treatment decisions in an asthma specialty clinic. Ann Allergy Asthma Immunol. 2014;113(6):619-623. 12. Lester D et al. An investigation of asthma care best practices in a community health center. J Health Care Poor Underserved. 2012;23(suppl 3):255-264. 13. Honkoop PJ et al; Asthma Control Cost-Utility Randomized Trial Evaluation (ACCURATE) Study Group. Symptom- and fraction of exhaled nitric oxide-driven strategies for asthma control: a cluster-randomized trial in primary care. J Allergy Clin Immunol. 2015;135(3):682-688. 14. National Institute for Health and Care Excellence. Measuring fractional exhaled nitric oxide concentration in asthma: NIOX MINO, NIOX VERO and NObreath. <http://www.nice.org.uk/guidance/dg12>. Zugriff am 31. März 2016. 15. Kapande KM et al. Comparative repeatability of two handheld fractional exhaled nitric oxide monitors. Pediatr Pulmonol. 2012;47(6):546-550.



Severe asthma; where are our patients and what should be done with them?

4th King's Paediatric Respiratory Conference

Venue: Bush Centre, 30 Aldwych, London

Date and time: Wednesday 18th April 2018

17.15 - 18.45

Presenters: Dr Louise Fleming, Clinical Senior Lecturer Paediatric Respiratory Medicine

Dr Will Carroll, Consultant in Paediatric Respiratory Medicine

Registration and contact details: Please contact Michelle on 07966118120 or michelle.osafo@novartis.com or Register via the conference app



Promotional Symposium organised and funded by Novartis Pharmaceuticals UK.

This symposium is open to healthcare professionals only.

XSA18-C006b(2)
April 2018



POSTER PRESENTATIONS ABSTRACTS

Name	Category	Title
A1 MCMURRAY A ¹ , FLEMING L ² , CUNNINGHAM S ¹	Asthma, Allergies	Defining Acute Asthma Severity – How Do Worldwide Asthma Guidelines Compare?
A2 VEERAKORN ACHAKULWISUT, HELEN BLAMEY, ASHLEIGH DRAPER, STUART INNES, SARAH LATHAM, CHARLES SOUTHEY, EUGENE YAP, ATUL GUPTA	Asthma, Allergies	Using Remote Direct Observation Therapy to Improve Asthma Inhaler Technique
A3 BAKER C, COXALL K, KUMAR P, EASTHAM K	Asthma, Allergies	Development of an Electronic Paediatric Emergency Department Asthma Assessment Tool (PEDAAT) to Identify High Risk Children in Accordance with the National Review of Asthma Deaths (NRAD) 2014 Standards
A4 COLETTE DATT, DR JOHN MOREIRAS, DR AMIR HAKIM, DR MYRA STERN	Asthma, Allergies	Disclosure of Smoking in Adolescents- A Feasibility Study
A5 BIJU THOMAS ^{1,5} , MEI LING CHUA ² , DYAN ZHANG ZHEWEI ¹ , CRYSTAL YU FANG HAY ² , RESHMI DAS ³ , JOHN E CONNOLLY ⁴ , TEOH OON HOE ^{1,5} , ARUN PUGALENTHI ^{1,5} , SAJI GEORGE ^{2,6}	Asthma, Allergies	Air Pollution: Effects of Biomass Burning Generated Particulate Matter on Bronchial Epithelial Cells
A6 DR HAJI SHEERAZ KHAN, DR MARY BARRACLOUGH	Asthma, Allergies	Are We Fully Aware of our Child's Asthma Medications? Oh, I Thought the Inhaler Was Still Full!
A7 DR LOUISE SELBY ¹ , DR FRANCES BERESFORD ¹ , PROFESSOR ANDREW BUSH ^{1,2} , PROFESSOR SEJAL SAGLANI ^{1,2} , ANGELA JAMALZADEH ¹ , RACHAEL MOORE-CROUCH ¹ , PIPPA HALL ¹ , DR LOUISE FLEMING ^{1,2}	Asthma, Allergies	Emotional Distress in Children with Problematic Severe Asthma is Associated with Parental Anxiety and Depression
A8 SAVITHA M.R, SUDHA RUDRAPPA	Asthma, Allergies	A One Year Experience of Free Allergy Asthma Clinic Catering Mainly to Low and Middle Socioeconomic Class from South India
A9 SAVITHA M.R, YASHWANTH RAJU H.N	Asthma, Allergies	Latex Allergy Among Health Care Professionals at a Tertiary Care Government Hospital in South India
A10 REBECCA NORMANSELL ¹ , RACHEL KNIGHTLY ² , STEPHEN J. MILAN ³ , JENNIFER A. KNOPP-SIHOTA ⁴ , BRIAN H. ROWE ⁵ , COLIN POWELL ⁶	Asthma, Allergies	Inhaled Magnesium Sulfate for Acute Asthma in Children: Cochrane Review Update
A11 SHAHAMAH ALSHAHER, CLARE MURRAY	Asthma, Allergies	The Role of Pet Allergen Sensitisation and Exposure in Asthmatic Children
B1 AHMED, B ^{1,2} , COX, M.J. ¹ , CUTHBERTSON, L ¹ , JAMES, P ¹ , COOKSON, W.O.C. ¹ , DAVIES, J.C. ^{1,2} , MOFFATT, M.F. ¹ , BUSH, A ^{1,2}	Cystic Fibrosis	Early Development of the Airway Microbiota in Infants with CF
B2 HERA ASAD ¹ , TAVISHI KANWAR ¹ , SHANI DE SOYSA ¹ , USMAAN AHMED ² , HAROON AHMED ¹	Cystic Fibrosis	The Effect of Gastrostomy Insertion on Long-Term Pulmonary Function in Children With Cystic Fibrosis: A Systematic Review
B3 HANNAH SHIMMIN, PRITA RUGHANI, SARAH BROWN, CAROLINE PAO, CATHERINE LAMBERT, CHINEDU NWOKORO	Cystic Fibrosis	The Management of Non-Tuberculous Mycobacteria in Paediatric Patients with Cystic Fibrosis Compared with Current International Consensus Guidelines
C1 DR YASMINE KAMAL, DR GILLIAN ROBERTSON, DR CHRIS EDWARDS	Infections, Epidemiology, Suppurative Lung Disease	What are the Most Common Potentially Causative Factors in Children with Trisomy 21 that are Associated with Recurrent Respiratory Symptoms?
C2 DR. ALEX PAES, DR. WILL DAW, DR. CHRIS EDWARDS, DR. GUY, MR. CRABBE, MS. SIDEBOTHAM, DR. O'RIORDAN	Infections, Epidemiology, Suppurative Lung Disease	Miliary TB with Broncho-Pleural Fistulae and Cystic Parenchymal Changes on CT
C3 DR G. WILSON ¹ , DR P. DESAI ²	Infections, Epidemiology, Suppurative Lung Disease	Respiratory Syncytial Virus: Are the Goalposts Changing? Three Case Studies of Children over the Age of 2 Years with significant RSV Infections

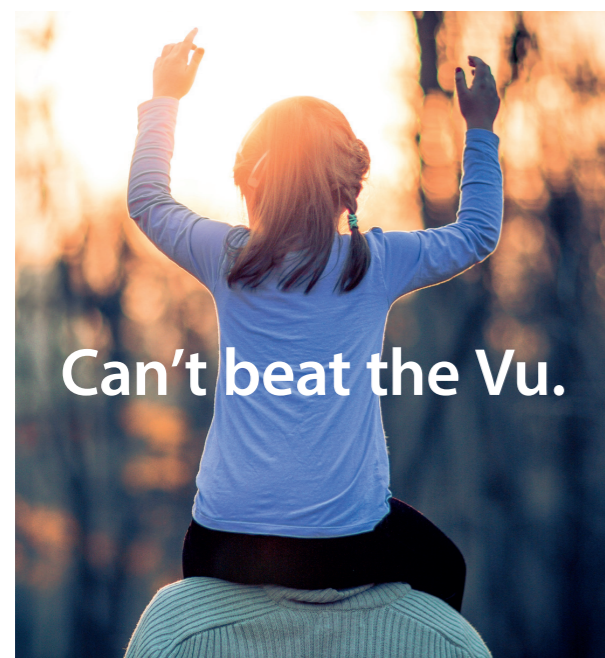

Can't beat the Vu.

NEW AeroChamber Plus* Flow-Vu* Anti-Static Valved Holding Chamber

Innovative design provides dose assurance and delivers improved clinical outcomes for patients using pMDI medication¹⁻⁴

See what it can do for your patients

Visit us at the Trudell Medical UK Limited stand to learn how AeroChamber Plus* Flow-Vu* Anti-Static VHC can help



AeroChamber Plus Flow-Vu
Anti-Static Valved Holding Chamber



References: 1. Harkness H, Sartori S, Mitchell JP. Valved Holding Chambers are non-interchangeable: development of a universal VHC that provides assurance of drug delivery to patients and health care providers. Presented at Canadian Respiratory Conference, Canada, 26-28 April 2012. 2. Mitchell JP, Ali R, Wang V, Nagel M and Suggett J. The attributes of an ideal universal valved holding chamber for use with pressurized metered dose inhalers. Presented at Respiratory Drug Delivery Europe, France, 5-8 May 2015. 3. Nagel MW, Suggett JA. Equivalence Evaluation of Valved Holding Chambers with Albuterol Pressurized Metered Dose Inhaler. Presented at Respiratory Drug Delivery Europe, France, 25-28 April 2017. 4. Burudpakdee C. et al. A retrospective study of the Effectiveness of AeroChamber Plus* Flow-Vu* Antistatic Valved Holding Chamber for Asthma Control. *Palm Ther* 2017;9(1):10.1007/s41030-017-0047-1.

pMDI, pressurised metered dose inhaler; VHC, valved holding chamber. Manufactured by: Trudell Medical International, 725 Third Street, London, Ontario, Canada, N5V 5G4 +1-866-510-0004 Distributed in the UK by: Trudell Medical UK Limited, Grove House, Lutyns Close, Basingstoke, Hampshire, RG24 8AG Tel 01256 338 400, Email info@trudellmedical.co.uk *Trademarks and registered trademarks of Trudell Medical International. © TMI 2018. All rights reserved. UK AC 030 0218 | Date of Preparation: February 2018

POSTER PRESENTATIONS
ABSTRACTS

C4	MOLLA I AHMED¹, YEAN L NG¹, MANJITH NARAYANAN¹	University Hospitals of Leicester	Infections, Epidemiology, Suppurative Lung Disease	Audit of Management of Chest Drains in Empyema
C5	L. ELLIOTT¹, T. RAHIMI¹, Q. WU¹, R. WELLS¹, N. ELHADI¹	West Middlesex University Hospital, Chelsea and Westminster NHS Trust	Infections, Epidemiology, Suppurative Lung Disease	Paediatric Tuberculosis Screening – Current Practice at a London District General Hospital
C6	DR SHRAVANTHI CHIGULLAPALLI, DR VENKAT THIYAGESH,	Calderdale Royal Hospital	Infections, Epidemiology, Suppurative Lung Disease	Podcast
D2	DR. BEATRICE ZANETTI, DR. RAHUL ROY	Norwich University Hospital NHS Trust	Neonatal Pulmonology, Bronchoscopy, Congenital Malformations, Respiratory Intensive Care & Airways	Inhaled Nitric Oxide Use In Persistent Pulmonary Hypertension of the Newborn: A Retrospective Audit in a Neonatal Intensive Care Unit
D3	M RANJAN¹, A JEYARAMAN², S HAMAD³	Hull Royal Infirmary	Neonatal Pulmonology, Bronchoscopy, Congenital Malformations, Respiratory Intensive Care & Airways	Case Report: A Novel Therapy for Severe Pulmonary Haemorrhage in Newborn
D4	E. J. D MAUGHAN¹, T. NZIRAWA²	1 Royal Brompton Hospital, 2 NICU Queens Hospital	Neonatal Pulmonology, Bronchoscopy, Congenital Malformations, Respiratory Intensive Care & Airways	Developing a Paediatric Pan London Oxygen discharge bundle to transform home oxygen discharge
E1	WALKER, ANNE MARIE; O'TOOLE, SOPHIE; LOWE, PAULA; KERR JOANNA; GAVLAK, JOHANNA; EVANS, HAZEL J.	Southampton Children's Hospital	Physiology, Sleep, NIV	Initiating and Titrating Ventilation in Children – Do Different Models of Delivery Affect Adherence and Health Economic Outcomes?
E2	EERO LAUHKONEN, SINDHU SIVAGNANASITHIYAR, RICHARD ILES	Evelina London Children's Hospital	Physiology, Sleep, NIV	Forced Oscillation Technique and Flow-Volume Spirometry in a Clinical Audit of 3-17 Years Old Asthmatic Children
E3	E.RUSSELL-JONES, C.MEAD-ROBSON, T.RADIA	Croydon University Hospital	Physiology, Sleep, NIV	The impact of Optiflow on Reducing Transfers to Other Hospitals in a Busy District General Paediatric Department
E4	DR. HAZEL EVANS DANIEL WILLIAMS	Southampton Children's Hospital	Physiology, Sleep, NIV	A Study Reporting the 3% Desaturation Index in Healthy Children Under 12 Years Using Masimo Technology
E5	TRUCCO F, BUSH A, TAN H-L	1 Royal Brompton Hospital 2 Imperial College	Physiology, Sleep, NIV	Role of CO2 Monitoring in the Diagnosis and Management of Paediatric Sleep Disordered Breathing
E6	FLORIAN GAHLEITNER, JENNIFER WESTWOOD, NATASHA LIDDLE, PAULA LOWE, JOHANNA GAVLAK, HAZEL J EVANS	Southampton Children's Hospital	Physiology, Sleep, NIV	The Impact of Artefact-Free Recording Time on Oximetry Outcome Variables
E7	MOLLA AHMED, DAVID LUYT	University Hospitals of Leicester	Physiology, Sleep, NIV	Evaluation of the sleep history in predicting Sleep Disordered breathing in children
E8	EZE-JOHN, P; CHOUDHURY, R	The Royal London Hospital, Barts Health NHS	Physiology, Sleep, NIV	Non-invasive Ventilation Therapy: Intervention is the Key to Management
E9	SALLY HOBSON¹, JENNA VYAS-LEE², KELLY WOOD², NAILA HAITHAM¹, JESSICA TURNBULL¹	1 Guys and St Thomas's Foundation Trust 2 South London and Maudsley Foundation Trust	Physiology, Sleep, NIV	Development and Evaluation of a Community Paediatric Sleep Clinic in two Inner London Boroughs
E10	DR WILLIAM DAW, DR RUTH KINGSHOTT, PROF HEATHER ELPHICK	Sheffield Children's Hospital	Physiology, Sleep, NIV	Wide Variation in Practices for Measuring Respiratory Rate in Children
E11	DR WILLIAM DAW, DR RUTH KINGSHOTT, PROF HEATHER ELPHIC	Sheffield Children's Hospital	Physiology, Sleep, NIV	Ordinal Scales Are Not Accurate to Assess and Measure Respiratory Rates in Children

ACKNOWLEDGEMENTS
CHAIR OF THE AWARDS: Prof Andy Bush

THANK YOU TO OUR ABSTRACT JUDGES:

- Dr Rania Abusamra
- Prof Paul Brand
- Dr Atul Gupta
- Dr Hui-Leng Tan
- Prof Andy Bush
- Dr Simon Broughton
- Dr Paolo Pianosi
- Dr Don Urquhart
- Dr Cara Bossley
- Dr Theodore Dassiof
- Prof Paul Seddon

SPONSORS

THANK YOU

PLATINUM

NUTRICIA
Early Life Nutrition

We would like to take the time to thank all of the organisations that have supported this year's conference:



EXHIBITORS



CONNECT TO CONFERENCE WI-FI

Bush House Conference facilities use **The Cloud** Network. There is a one-time authentication process to follow when you first visit a Cloud hotspot. Simply follow the steps below to register or login...

1. Check your WiFi is on by selecting '**Settings**' from your home screen and selecting '**Wi-Fi**'.
2. If you are within coverage of a Cloud hotspot, you'll be offered '**The Cloud**' - select this network.
3. Return to the home screen and upon opening your web browser, you'll see The Cloud landing page. If you don't - click to refresh the page.
4. Select '**Get Online**' and follow the onscreen instructions.
5. When the Wi-Fi session is established, you will see '**Welcome to The Cloud**' and the session counter displays the session time. You can now begin your Wi-Fi browsing session!

DOWNLOAD THE CONFERENCE APP

The Conference App contains even more useful information and resources. You will find speaker biographies and pictures, speaker abstracts, poster presenter abstracts, opportunities to network with other delegates and much, much more.

DOWNLOAD INSTRUCTIONS:

1. Go to the App Store or Google Play and download the **ATTENDIFY – NETWORK AT EVENTS** App.
2. Create a login (we suggest using the details you registered for the conference with)
3. Search for **4th KING'S J P PAED RESP CONF** and look for this icon:

